

# PRODUCT SUBMITTAL

**WIRE-BOND**

## # 4110 Anchorseal Tape

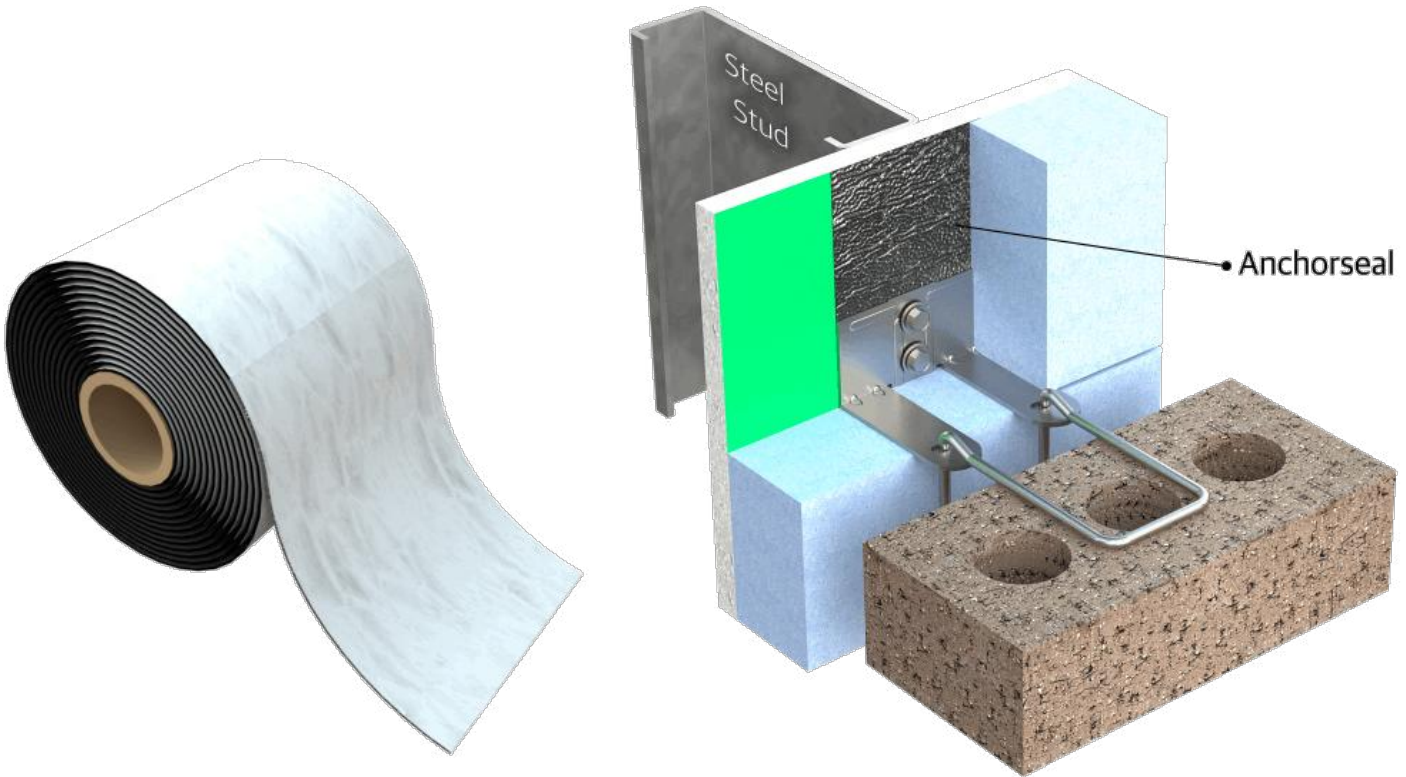

### COMPOSITION / MATERIALS

A 40 mil thick dual barrier membrane consisting of 32 mills of pliable, highly adhesive rubberized asphalt, completely and integrally bonded to an 8 mil, high density, cross-laminated polyethylene film.

Anchorseal is used in conjunction with, RJ711, Type II and Type III anchors.

Shown in illustration with the Type III anchor.

**Sizes: 40 mil x 3" wide**

**Standard roll length: 50 lineal feet.**



### TECHNICAL DATA

Property	Average Values	Test Method
MVT	0.02 grains max/sq.ft./hr inHG	ASTM E96 Method B
Water Absorption	-1% by weight. Max.	ASTM 0570
Pliability at 180° Bend over 1 / Z Mandrel	to -30 no crack or peel	ASTM 0146
Peel Adhesion (Dry)	i 0.0 lbs./in..min.	ASTM 0903
Peel Adhesion (Wet)	5.0 lbs./in., min..	ASTM 0903
Lap Adhesion at 25	6.0 lbs./in., min..	ASTM 1876
Elongation	350%	ASTM 0412
Tensile Strength (film)	7000 psi	ASTM 0882
(membrane)	800 psi	ASTM 0412
Puncture Resistance	90 lbs.. min.	(Die C Modified) ASTM E154
Rim	170 lbs.. min.	ASTM 0781
Tear Resistance		
Propitiation MO	12.0lbs.	ASTM 01938
Iniation MO	16lbs.	ASTM 01004

**Corporate Office:** 400 Rountree Rd Charlotte, NC 28217  
TEL: (800) 849-6722 FAX: (704) 525-3761

**Mailing Address:** P.O. Box 240988 Charlotte, NC 28224



[www.wirebond.com](http://www.wirebond.com)

**Memphis Plant:** 2365 Harbor Ave. Memphis, TN 38113  
TEL: (800) 441-8359 FAX: (901) 775-9449

**Mailing Address:** P.O. Box 13124 Memphis, TN 38113