

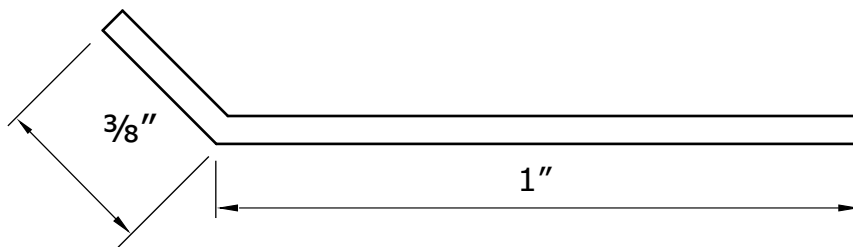

PRODUCT SUBMITTAL

WIRE-BOND

4210 Aluminum Termination Bar

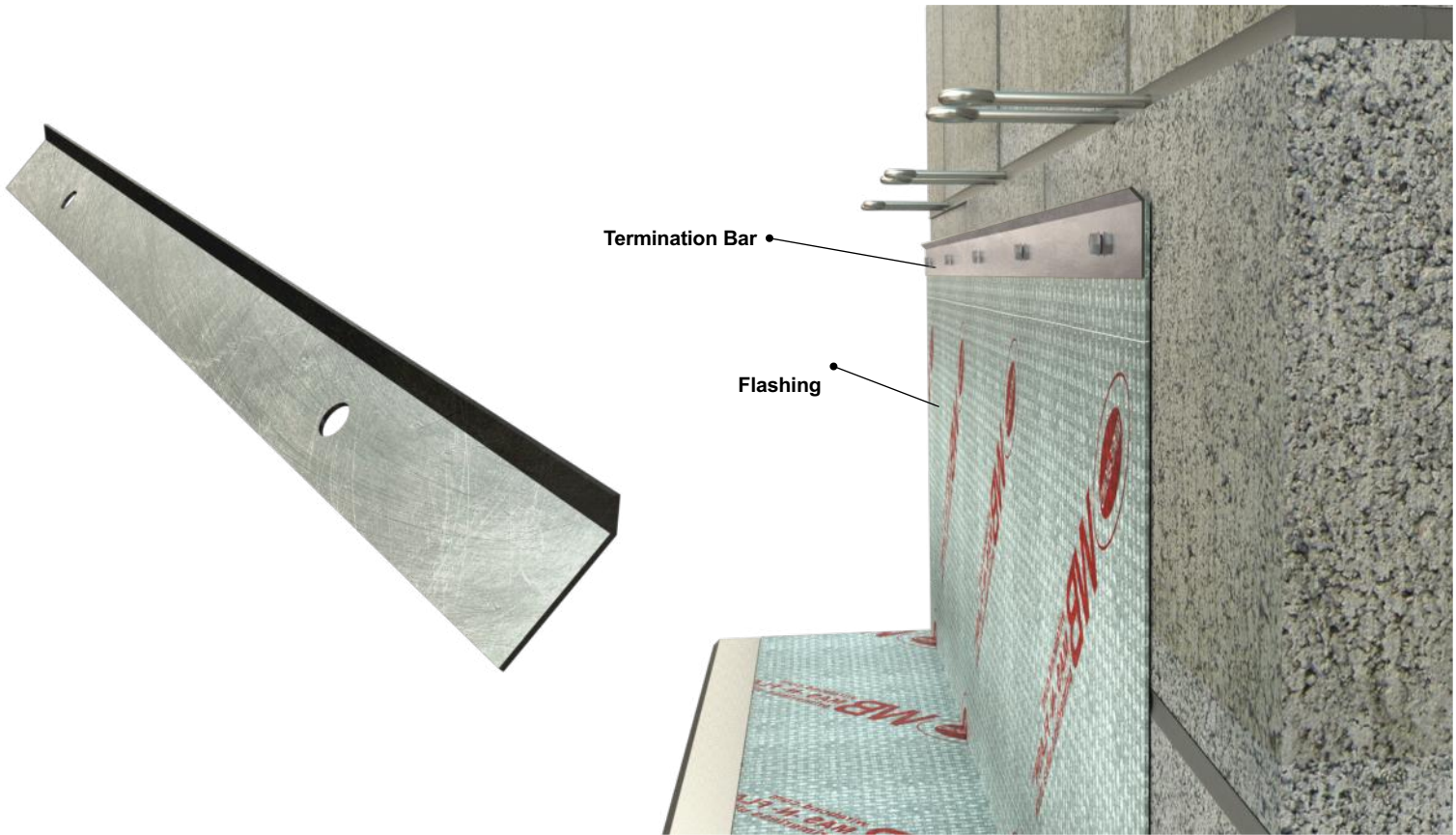

MATERIAL CONFORMANCE	SIZES / FINISHES
<p>SHEET METAL: Aluminum: ASTM B221 / ASTM B221M</p> <p>Steel Products (flats) Recycled Content:</p> <p>Aluminum 18% average (10% - 25% Range) Post Consumer 56% average (25% - 75% Range) Pre Consumer</p> <p>V O C Content - 0%</p> 	<p>#4210 Aluminum Termination Bar:</p> <p>14 gauge x 1" wide x 3/8" sealant lip by 10' sections 5/16" Slotted holes: 8" O.C. Aluminum: ASTM B221 / ASTM B221M</p>

WIRE-BOND

www.wirebond.com

Distributed by:
MasonAccess.com
 (800) 924-6802