

Termination Bar – Stainless Steel

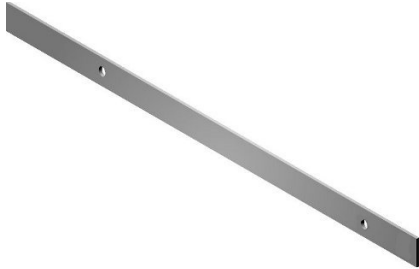

Product Information:

Uses:

- Used to surface mount flashing to an existing substrate. Start fastening from one end of the bar and proceed to the next hole to avoid bowing. Apply a sealant to the top edge of the bar and feather.

Dimension:

- Standard Size: 1/8" x 1" wide x 8'0" long with 5/16" diameter holes 16" o.c. starting 8" from each end.

Finish:

- Stainless Steel – Type 304
ASTM A240/A240M, ASTM A666, ASTM A480/A480M, and ASTM A167

Advantages:

- Simple and economical to install
- Works with Wood, Metal Stud, CMU & Concrete Substrates

Fasteners

Screws – for Metal Stud Framing



Screws – for Wood Framing



Hit Pins – for CMU & Concrete



For technical assistance call us toll free at 1-800-924-6802.