



Moisture
Management
for Masonry

Your reputation. Your legacy. Our mission.

 **BlockFlash™**

BLOCKFLASH™ - A COMPLETE FLASHING SOLUTION FOR SINGLE-WYTHE CONCRETE MASONRY UNIT WALLS

Technical Data Sheet

Description

It uses patented flashing pans to collect moisture in the wall and channel it to the exterior through integrated weep spouts. Its included drainage mesh provides hundreds of clear pathways for water to flow around mortar droppings inside the block cells so it can be collected by the pans.

Features

- High-density polypropylene sloped flashing pans with integrated edge flanges, integrated weep spouts catch and funnel water to the wall exterior
- 7" x 14" drainage mats made of 90% open weave polyester mesh
- Factory-installed 90% open weave polyester mesh insect guards keep insects out of the block cells
- Available for 6", 8", 10", 12" standard or insulated CMUs
- Snap-off connector bridge allows fast and easy pan installation in reinforced wall systems and at corners
- Integrated alignment lip on weep spout makes it fast and easy to accurately align flashing pans with block face

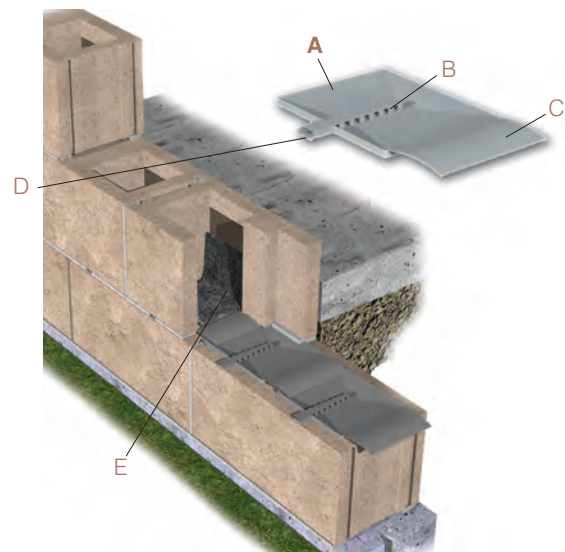

- A. BlockFlash flashing pan
- B. Weep Spouts
- C. Connector Bridges
- D. Insect Guards
- E. Drainage Mat

Sizes and Packaging

PAN	HEIGHT	WIDTH	LENGTH	PANS + DRAINAGE MATS/BOX
6"	5/16"	4 1/8"	6 3/4"	100
8"	5/16"	5 5/8"	6 3/4"	100
10"	5/16"	7 5/8"	6 3/4"	100
12"	5/16"	9 5/8"	6 3/4"	100

Recycled Content

MATERIAL	RECYCLED CONTENT
Flashing pan	40% Pre-consumer
Drainage mesh	40% Pre-consumer

Quantity Formula

To determine the number of pans needed on your wall, use this formula:

$$\# \text{ of pans needed} = [(\text{LF of wall} \times 0.75) \times 2] \text{ minus } \# \text{ of grouted cells}$$